



A Quality Office Environment

midPlaza

www.midplaza.com



exterior of photograph
MIDPLAZA BUILDINGS

PT. MIDPLAZA PRIMA

MidPlaza 2, 25th Floor

Jl. Jend. Sudirman Kav. 10-11

Jakarta 10220, Indonesia

Tel : (62.21) 570.0599, 570.7555

Fax : (62.21) 573.4555

Email : marketing@midplaza.com

typical floor plan

MIDPLAZA 1

- Whole floor space of 1135 m².
- Rentable areas range from 50 m² upward.

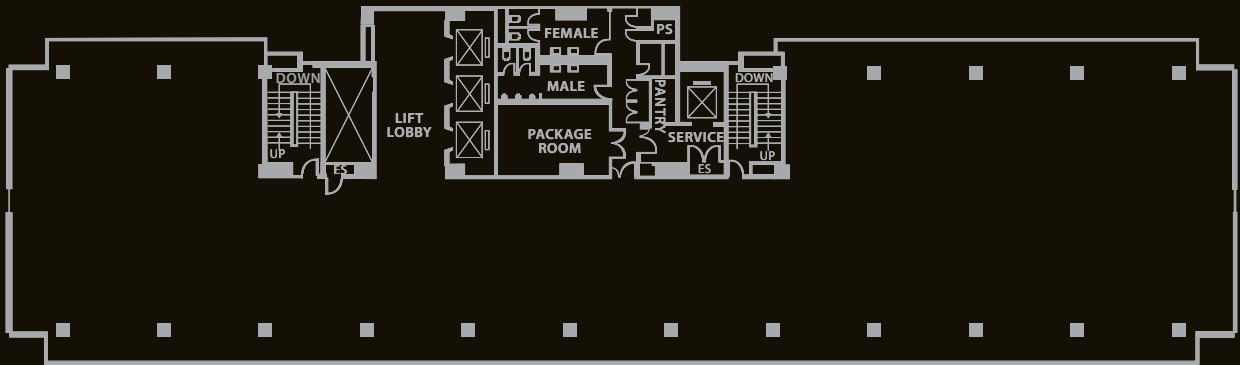

typical floor plan

MIDPLAZA 2

- Whole floor office space of 1125 m².
- Rentable areas range from 90 m² upward.
- Has 8 (eight) corners of office space on any typical floor.

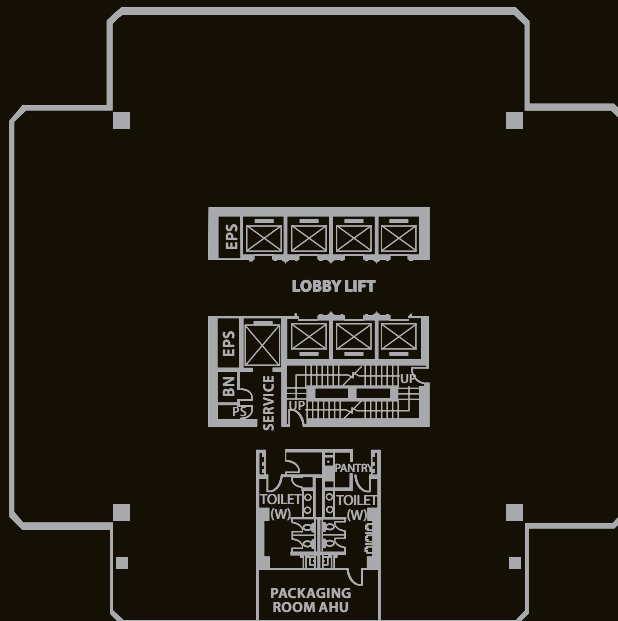

Executive toilet amenities and pantry at each floor. Under floor trunking system for power, computer and telephone cable.

BUSINESS AT THE HEART OF JAKARTA

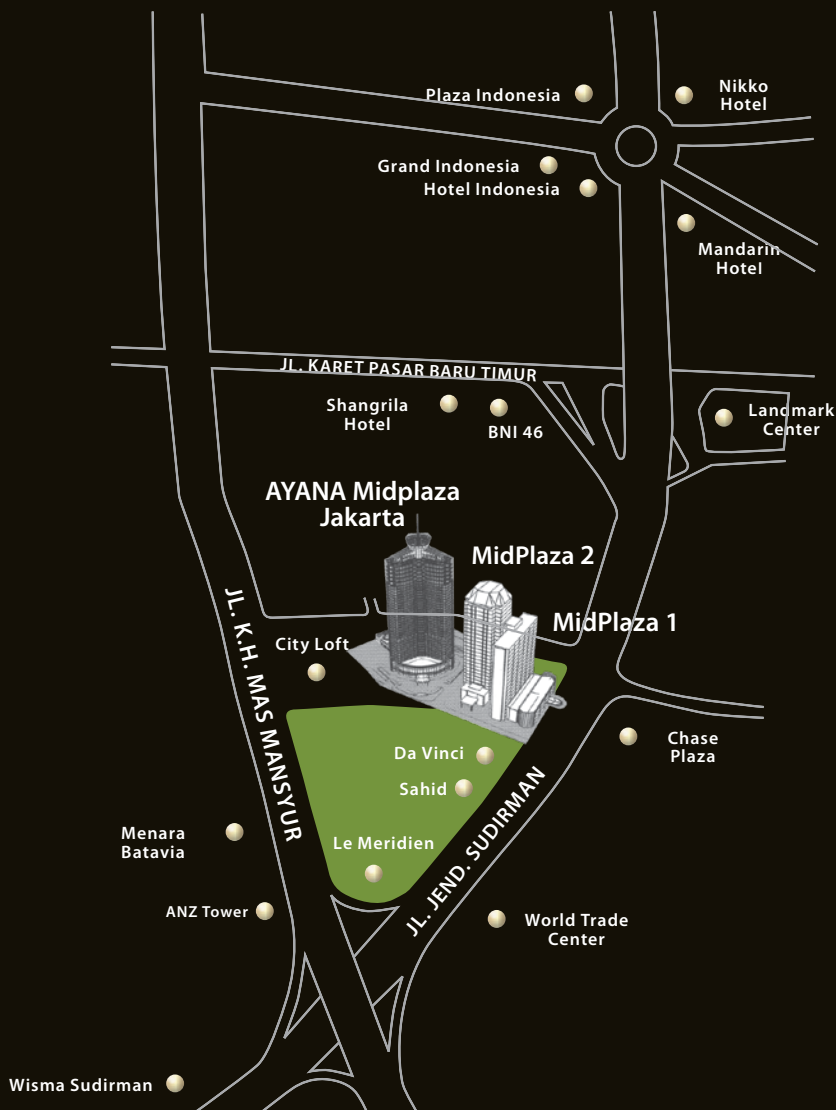

In the best location of Jakarta's Golden Triangle. Easy access to East, West, North or South of Jakarta and prime residential areas such as Kemang, Permata Hijau and Pondok Indah. Close to Semanggi Interchange for direct access to Soekarno Hatta Airport. Two-way access via Jl. Jend. Sudirman & Jl. K.H. Mas Mansyur. The latter serves to overcome there-in-one traffic restriction.



ABOUT MIDPLAZA

At the centre of Jakarta's urban pulse, MidPlaza is a business oasis designed with one purpose in mind: total convenience. MidPlaza's two towers fuse office space with retail and recreation in an environment of simple refinement.

With two-way access via Jl. Jend. Sudirman and Jl. K.H. Mas Mansyur, MidPlaza is strategically located to beat Jakarta's traffic gridlock and is just minutes from the offices of major corporations. The luxurious Hotel AYANA

Midplaza Jakarta and Plaza Residences are linked by air-conditioned footpath to ensure ease of access.

At MidPlaza 1 and 2, the watchword is reliability. The buildings boast high-quality design and construction by Japan's renowned Shimizu Corporation. Cutting-edge IT infrastructure by our company, Biznet, guarantees high-speed, uninterrupted web access and video conferencing. 24-hour security, state-of-the-art meeting

facilities and over 1,500 parking spaces mean hassle-free business.

MidPlaza is about more than just work. The complex is home to restaurants and bars offering cosmopolitan fare ranging from Chinese to Italian, Japanese and Indonesian. With access to spa and gym facilities as well as specialty and convenience stores, MidPlaza offers you a fully rounded experience.





CUTTING EDGE TECHNOLOGY

The core of business today is reliable, fast information technology. Backed by Biznet, MidPlaza provides high-speed Internet with an up to one-gigabyte fiber-optic backbone at an affordable price.

Our 700 square meter global standard Biznet Data Center can host over 5,000 servers. At data speeds of up to 2.5 Gigabits per second, our technology infrastructure supports leased lines, Frame Relay, Asynchronous Transfer Mode (ATM) and ultra-fast web access. Fast Internet means uninhibited access to live video and audio, enabling high-quality, worldwide Video Conferencing.

MidPlaza ensures uninterrupted communications with mobile phone signals for major operators on all levels, basements and elevators. Our MidPlaza Information Network Interchange (MINI) runs more than two kilometers of fiber optic cable through several buildings, guaranteeing a seamless connection.





FACILITIES

As one all-embracing superblock, MidPlaza offers the complete combination for work, relaxation and recreation.

We offer modern office space at competitive prices for you to grow your business. More than 15 restaurants serve cuisine from across the globe, including Chinese, Japanese, Indonesian and European cuisines.

Our bars and lounges offer casual ambience and elegance in which to unwind.

Diverse shopping runs through to the Hotel AYANA Midplaza Jakarta, linked by underground path to MidPlaza 1 and 2, ranges from top international brands right through to the finest Indonesia has to offer. The superblock contains a full range of amenities including bank-

ing and postal services, a salon, money changing, photocopying, a travel agency, convenience stores, skin and dental clinics and a florist.

Health facilities at the Hotel AYANA Midplaza Jakarta include a full gymnasium, swimming pool, hot and cold whirlpools, private massage and tennis courts.

